

Controlled Drug System Heat Seal Kit

The Controlled Drug System kit includes 200 cards and blisters. The Controlled Drug Card is a 25-dose hermetically heat sealed blister package. The hinged spine allows the front cover to close over the blister to protect its integrity when not in use. The unique design of the blister allows pharmacy to package either tablet or capsule forms of controlled substances. The raised top edge of the card contains the drug detail which is quickly and easily identified. Available by kit of 200.

KIT ITEM NUMBER:	SIZE:	COLOR:
MBM25	Small	Clear
MBM25A	Small	Amber

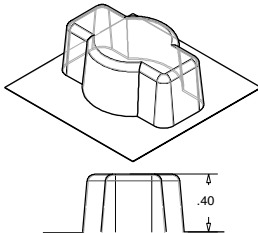
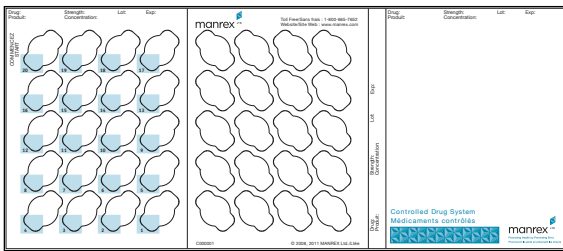

Controlled Drug System Pressure Sensitive Kit

Our Pressure Sensitive Controlled Drug System kit includes 200 cards and blisters. The Controlled Drug Card is a 20-dose hermetically sealed blister package that does not require heat sealing. The hinged spine allows the front cover to close over the blister to protect its integrity when not in use. The unique design of the blister allows pharmacy to package either tablet or capsule forms of controlled substances, along with larger medications, such as Hydromorph. Available by kit of 200.

KIT ITEM NUMBER:	SIZE:	COLOR:
MBM26	Deep	Clear
MBM26A	Deep	Amber

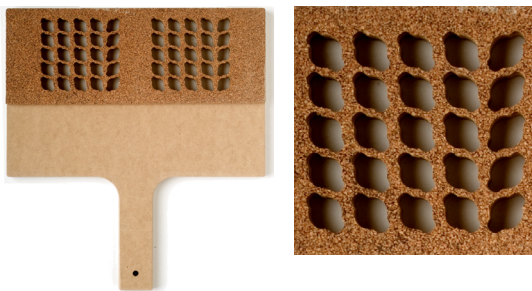

Controlled Drug 25 Dose Platen

The Controlled Drug Platen is made of MDF with a cork surface. It is durable, light and easy to use. A strong, uniform seal is achieved on every card. This platen can seal two Controlled Drug Cards at a time.

ITEM NUMBER: 40-002 - Available individually

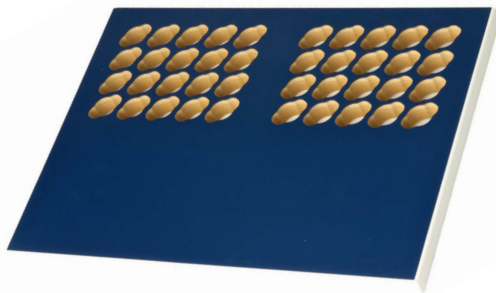

Controlled Drug 20 Dose Platen

The Controlled Drug Platen for the 20 dose pressure sensitive system is made of MDF with a laminate surface. It is durable, light and easy to use. A strong, uniform seal is achieved on every card. This platen will seal two Pressure Sensitive Controlled Drug Cards at a time.

ITEM NUMBER: 40-007 - Available individually



Roller

A Speedball Rubber Brayer 4" roller that provides even seal pressure.

ITEM NUMBER: 36-016



Controlled Drug Chart

The Controlled Drug Chart is a piggy-back sign-off label that is adhered to the inside front cover of the Controlled Drug Card by pharmacy. As each dose is administered from the card the corresponding blister administration number is signed-off on the chart. When the card is empty the top ply of the label is peeled off and put into a permanent narcotic record book. Controlled Drug Card not included.

ITEM NUMBER: 1027 - Package of 200 Chart Labels

